

# R-254 & R-255

## Auxiliary Heaters

### RV • TRUCKS

Tried and true, our R-254 (single-fan) and R-255 (double-fan) auxiliary heaters are among the most versatile and maintenance-free heaters you'll find. Their round-tube-and-fin design lets you mount these heaters in any position using our multi-position leg brackets or flush-mount frame, and their compact size, simple plumbing, and high output make them ideal for any application.

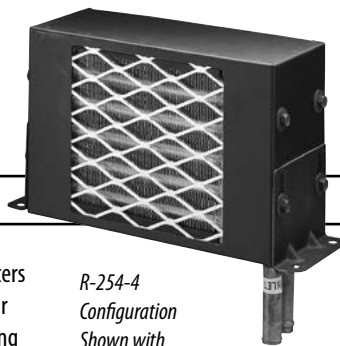

R-254-4  
Configuration  
Shown with  
mounting legs, floor  
exit



R-254-0  
Shown with  
mounting legs,  
rear exit

### SPECIFICATIONS

	R-254	R-255
<b>BTUs</b>	16,000 BTU/Hr @ 150°F (4.69kw @ 65.6°C) air temp. rise	30,000 BTU/Hr @ 100°F (8.79kw @ 37.8°C) air temp. rise
<b>AIR FLOW</b>	150 CFM (255 m <sup>3</sup> /h)	280 CFM (476 m <sup>3</sup> /h)
<b>WEIGHT</b>	7 lbs. (3 kg)	12 lbs. (5.5 kg)
<b>CURRENT DRAW</b>	3.3 amps @ 13.6 VDC 1.7 amps @ 27.2 VDC	6.6 amps @ 13.6 VDC 3.3 amps @ 27.2 VDC
<b>MODELS</b>	<b>Single Fan</b> 5/8" fittings, rear exit: R-254-0P (12 VDC) R-254-0-24P (24 VDC) 3/4" fittings, rear exit: R-254-1P (12 VDC)	<b>Double Fan</b> 5/8" fittings, rear exit: R-255-10P (12 VDC) R-255-10-24P (24 VDC)
	FLOOR EXIT 5/8" fittings: R-254-4P (12 VDC)	FLOOR EXIT 5/8" fittings: R-255-12P (12 VDC)

### OPTIONS:

**Heater Hose**  
78R0100

**Toggle Switch**  
71R0100

**Defrost Hose Outlet 3 1/2"**  
RD-1-0639-0P

**5/8" to 3/4" Adapter**  
70R7110

**Control Panel**  
71R5819  
Heater control -  
Two-speed motor switch with manual water valve control

Diagrams for R-254

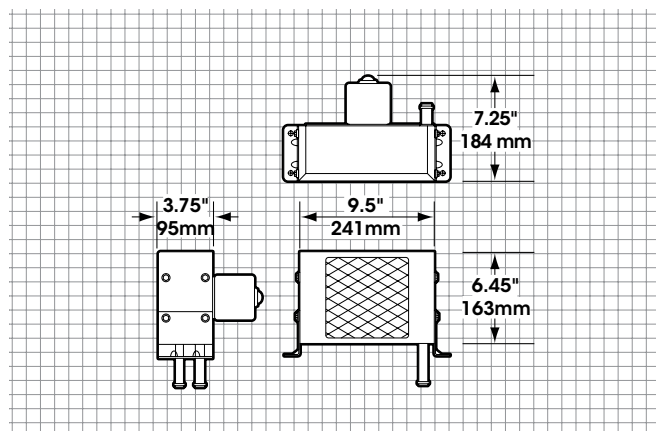

Diagrams for R-255

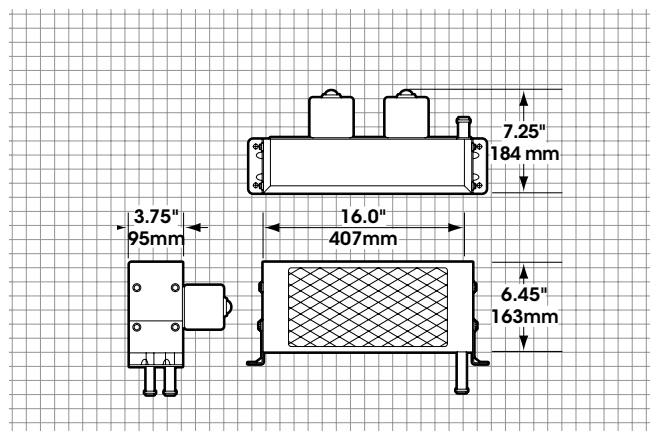

HEATER ONLY

## R-270 Auxiliary Heater

RV • TRUCKS

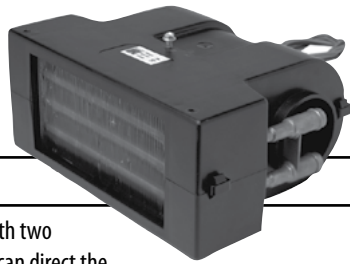

The R-270 is a compact heater with two optional "snap-in" outlets so you can direct the air to where you need it.

### R-270 SPECIFICATIONS

<b>BTUs</b>	Heating – 15,000 BTU/Hr @ 100°F air temp. rise (4.4 kW @ 34.8°C)
<b>AIR FLOW</b>	140 CFM (237 m <sup>3</sup> /h)
<b>WEIGHT</b>	7 lbs. (3 kg)
<b>MOTORS</b>	One 12 VDC (2-speed)
<b>CURRENT DRAW</b>	7.7 amps @ 13.6 VDC 3.8 amps @ 27.2 VDC
<b>UNITS</b>	R-270-0P (12 VDC) R-270-0-24P (24 VDC)

### OPTIONS:

#### Snap In Outlets

**Straight 2 1/4" Hose Outlet**  
72R4532



**Louvered Outlet**  
72R3157



**Installation Kit**  
RD-1-1654-0P 12VDC

**Control Panel**  
71R5819  
Heater control -  
Two-speed motor switch with manual  
water valve control

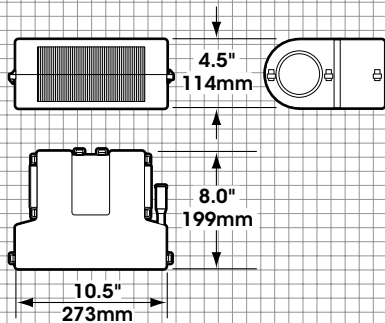

## R-273 Auxiliary Heater

RV • TRUCKS



The R-273 is a compact heater with optional "snap-in" outlet so you can direct the air to where you need it.

### R-273 SPECIFICATIONS

<b>BTUs</b>	Heating – 14,000 BTU/Hr @ 100°F air temp. rise (4.1 kW @ 34.8°C)
<b>AIR FLOW</b>	129 CFM (220 m <sup>3</sup> /h)
<b>WEIGHT</b>	3 lbs. (1.35 kg)
<b>MOTORS</b>	One 12 VDC (3-speed)
<b>CURRENT DRAW</b>	4.6 amps @ 13.6 VDC 2.3 amps @ 27.2 VDC
<b>UNITS</b>	R-273-0P (12 VDC) R-273-0-24P (24 VDC)

### OPTIONS:

#### Louvers

RD-5-14071-0P



#### Installation Kit

RD-1-1654-0P

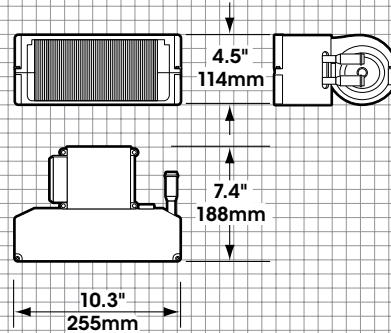

# R-290

## Auxiliary Heater (Single Blower)

The R-290 is a compact, high-velocity heater with a single three-speed blower motor. A defrost hose adapter is available for ducting air.

R-290 SPECIFICATIONS	
<b>BTUs</b>	20,000 BTU/Hr @ 150°F (kw 5.86 @ 65.6°C) air temp. rise
<b>AIR FLOW</b>	220 CFM (373 m <sup>3</sup> /h)
<b>WEIGHT</b>	7 lbs. (3 kg)
<b>CURRENT DRAW</b>	4.3 amps @ 13.6 VDC (high speed) 2.7 amps @ 27.2 VDC (high speed)
<b>MODELS</b>	R-290-0P (12 VDC), 5/8 fitting rear exit R-290-0-24P (24 VDC), 5/8 fitting rear exit <b>LS</b> R-290-4P (12 VDC), 5/8 fitting floor exit R-290-4-24P (24 VDC), 5/8 fitting floor exit

**LS** = Limited to stock on hand



### OPTIONS:

<b>Defrost Hose Outlet Adapter</b>	<b>Switch</b>	<b>Knob</b>
3 1/2" RD-1-0639-0P	71R1150	71R4050

#### Control Panel

- 71R5821 Heater control – Three-speed motor switch with manual water valve control
- 71R5823 Heater control – Three-speed motor switch with electronic water valve control

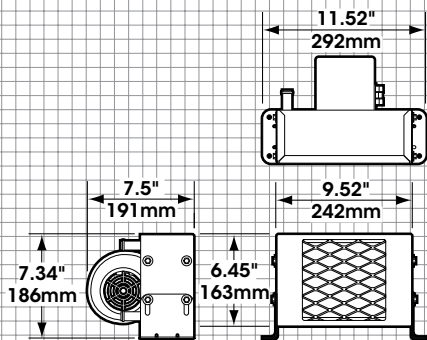

# R-295

## Auxiliary Heater (Double Blower)

With a three-speed blower motor, the R-295 produces 430 CFM—a powerful, compact, and robust heater. A defrost hose adapter is available for ducting air.

R-295 SPECIFICATIONS	
<b>BTUs</b>	35,000 BTU/Hr @ 180°F (kw 10.25 @ 82°C) air temp. rise
<b>AIR FLOW</b>	430 CFM (730 m <sup>3</sup> /h)
<b>WEIGHT</b>	11 lbs. (5 kg)
<b>CURRENT DRAW</b>	16 amps @ 13.6 VDC (high speed) 7 amps @ 27.2 VDC (high speed)
<b>UNITS</b>	R-295-0P (12 VDC), 5/8 fitting rear exit R-295-0-24P (24 VDC), 5/8 fitting rear exit R-295-4P (12 VDC), 5/8 fitting floor exit

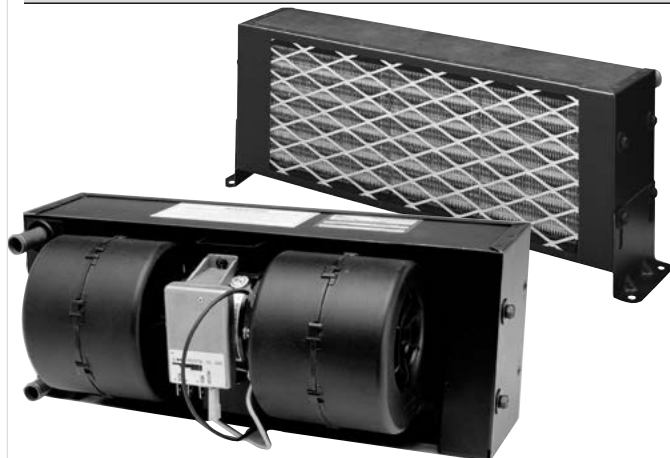

### OPTIONS:

<b>Defrost Hose Outlet Adapter</b>	<b>Switch</b>	<b>Knob</b>
3 1/2" RD-1-0639-0P (uses two)	71R1150	71R4050

#### Control Panel

- 71R5821 Heater control – Three-speed motor switch with manual water valve control
- 71R5823 Heater control – Three-speed motor switch with electronic water valve control

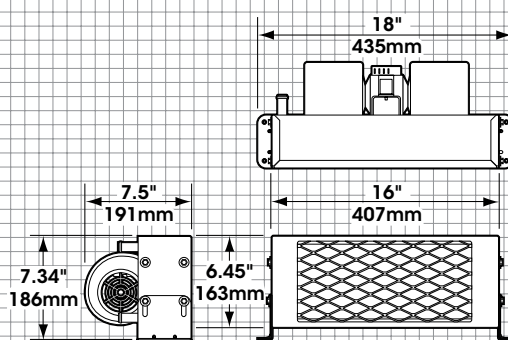

HEATER ONLY

# R-297

## Auxiliary Double Blower Heater

### TRUCK SLEEPERS

The R-297 is a powerful, three-speed floor-mounted heater for cabs used in demanding environments.

#### R-297 SPECIFICATIONS

<b>BTUs</b>	Heating - 28,000 BTU/Hr	
<b>AIR FLOW</b>	300 CFM (510 m <sup>3</sup> /h)	
<b>WEIGHT</b>	9.8 lbs. (4 kg)	
<b>CURRENT DRAW</b>	6A @ 27V 12A @ 13.5V	
<b>UNITS</b>	R-297-0P	12 VDC
	R-297-0-24P	24 VDC

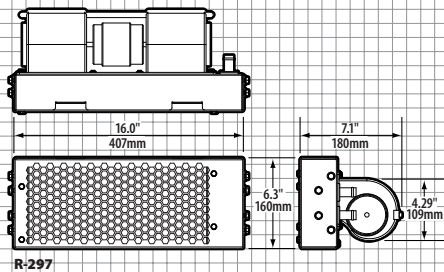

R-297

HEATER ONLY

# R-2020

## Auxiliary Heater-Defrost and Oil Cooler

### MARINE • INDUSTRIAL • CONSTRUCTION

#### R-2020 SPECIFICATIONS

<b>BTUs</b>	Heat - 17,800 BTU/Hr @ 100°F (kw 5.21 @ 37.8°C) with water for heat source (BTU's per hour with oil for heat source lower)
<b>AIR FLOW</b>	165 CFM (280 m <sup>3</sup> /h)
<b>WEIGHT</b>	10.7 lbs. (4.85 kg)
<b>MOTOR</b>	One 12 VDC or one 24 VDC single speed
<b>CURRENT DRAW</b>	6 amps @ 13.6 VDC, 3 amps @ 27.2 VDC
<b>UNITS</b>	R-2020-0P (12 VDC), R-2020-0-24P (24 VDC)

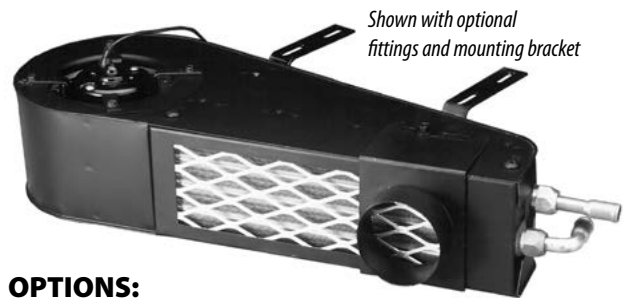

Shown with optional fittings and mounting bracket

#### OPTIONS:

##### 2 1/2" Defrost Adapter

72R3601

##### 3" Defrost Adapter

72R3603

##### Swivel Fittings

70R7600 (Straight 5/8" hose)

70R7650 (90° 5/8" hose)

##### Hoses

78R0100 (Heater, 5/8" 50ft)

78R0250 (Defrost, 2 1/2" 9ft)

78R0300 (Defrost, 3" 9ft)

##### Switches

71R0050 (Toggle, ON-OFF)

71R1210 (Rotary, 3-speed)

##### Mounting Bracket

RD-1-0419-0P

##### Control Panel

71R5817 Heater control - Single speed motor switch with manual water valve control

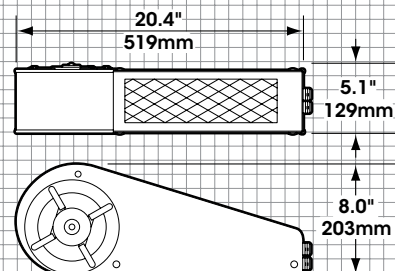

# R-3500 HEATER

## Auxiliary Heater

### CRASH/FIRE/RESCUE • CREW CABS

The R-3500 crew cab heater was designed with high performance to be able to heat larger cabs in extreme conditions. Its low profile and heavy duty construction allows this heater to be used in various applications.

#### R-3500 SPECIFICATIONS

<b>BTUs</b>	Heating – 49,000 BTU/Hr @ 180°F (kw 14.35 @ 82.2°C) temp. rise
<b>AIR FLOW</b>	480 CFM (816 m <sup>3</sup> /h)
<b>WEIGHT</b>	28 lbs. (13 kg)
<b>CURRENT DRAW</b>	15.9 amps @ 13.6 VDC
<b>UNITS</b>	R-3500-1P (12 VDC)



NOTE: Gasket on front

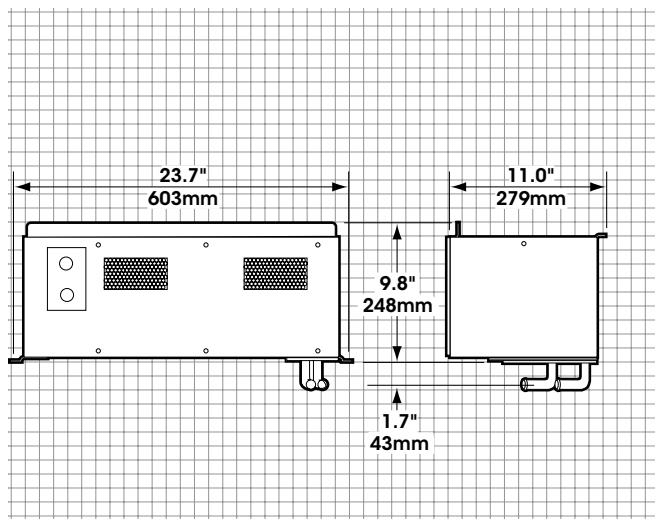

# R-3540 HEATERS

## Auxiliary Heater

### CRASH/FIRE/RESCUE • VAN • BUS

Designed for small spaces, the R-3540 delivers high capacity for its size. With a pancake fan design, this unit is quiet and moves close to 200 CFM of air. It has versatile mounting (flat or horizontal) and a resistor for variable speed control.

#### R-3540 SPECIFICATIONS

<b>BTUs</b>	22,970 BTU/Hr @ 180°F (kw 6.73 @ 82.6°C) air temp. rise
<b>AIR FLOW</b>	194 CFM (330 m <sup>3</sup> /h)
<b>WEIGHT</b>	10 lbs. (4.5 kg)
<b>CURRENT DRAW</b>	4.8 amps @ 13.6 VDC
<b>UNITS</b>	R-3540-2P (12 VDC)

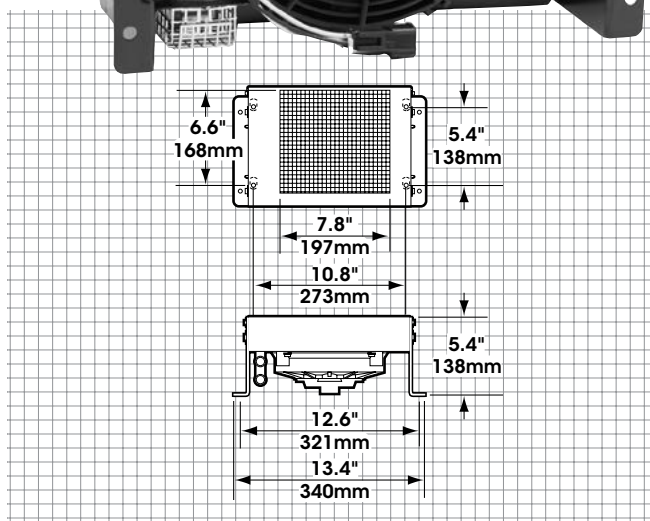
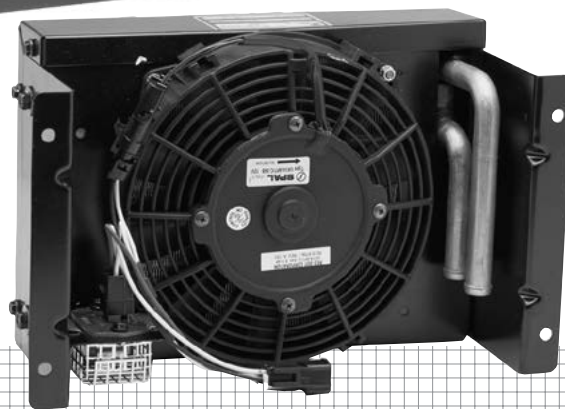
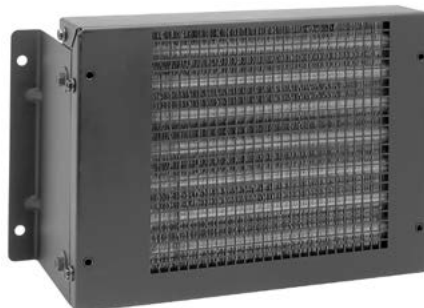

HEATER ONLY

## R-4013H

### Heater/Defroster

**CONSTRUCTION •  
MINING •  
AGRICULTURE •  
INDUSTRIAL**



The R-4013H is a compact, versatile, and high-output heater/defroster. Like other Red Dot heaters, the tube and fin coil design allows mounting in any position. A diversion door can be manually or cable-actuated to control defrost and heat output. An optional adapter to the heat outlet turns the R-4013 into a dual defroster or multi-compartment heater.

#### R-4013H SPECIFICATIONS

<b>BTUs</b>	Heating – 20,000 BTU/Hr @ 100°F (5.7 kW @ 37.8°C) air temp. rise
<b>AIR FLOW</b>	185 CFM (314 m <sup>3</sup> /h)
<b>WEIGHT</b>	15.7 lbs. (7.1 kg)
<b>CURRENT DRAW</b>	11 amps @ 13.6 VDC, 5.5 amps @ 27.2 VDC
<b>UNITS</b>	R-4013HP (12 VDC) For 24 volt see R-6130 (right)

#### OPTIONS:

**Heater Hose**      **3 1/2" Defrost Adapter**  
5/8" – 50'              72R3550  
78R0100



#### Control Panel

71R5819 Heater control - Two-speed motor switch with manual water valve control

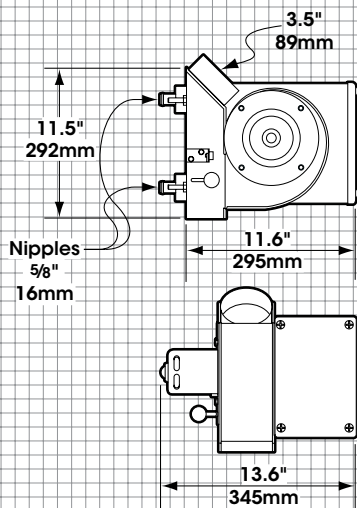

## R-6130

### Box Heater

**BUS •  
CONSTRUCTION •  
MINING •  
AGRICULTURE •  
INDUSTRIAL**

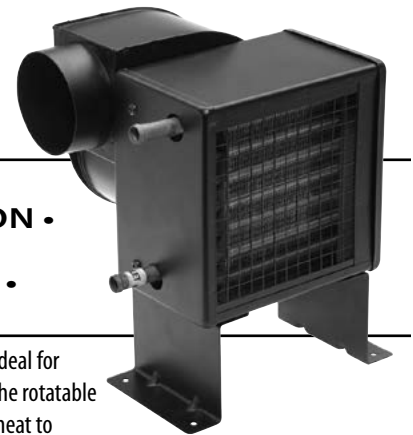

The R-6130's compact size is ideal for mounting in tight areas and the rotatable blower makes it easy to duct heat to where you need it.

#### R-6130 SPECIFICATIONS

<b>BTUs</b>	Heating – 28,100 BTU/Hr @ 180°F (8.2 kW @ 37.8°C) air temp. rise
<b>AIR FLOW</b>	283 CFM (481 m <sup>3</sup> )
<b>UNITS</b>	R-6130-1P (12 VDC) R-6130-0P (24 VDC)

#### OPTIONS:

##### Control Panel

71R5819 Heater control - Two-speed motor switch with manual water valve control

